

RUGBY BOROUGH COUNCIL
TOWN AND COUNTRY PLANNING ACT 1990 SECTION 257
THE BOROUGH OF RUGBY
(FOOTPATH R168Y RUGBY)
PUBLIC PATH ORDER 2024

This Order is made by the Rugby Borough Council (“the Council”) under Section 257 of the Town and Country Planning Act 1990 because it is satisfied that it is necessary to stop up **Footpath R168Y** and create a new **footpath** to which this Order relates in order to enable development to be carried out in accordance with planning permission granted under Part III of the Town and Country Planning Act 1990 by the Council for demolition of farmhouse and outbuildings and construction of Warehousing and distribution, fire station and infrastructure ,
Reference Number 16/2569

BY THIS ORDER

1. Footpath R168Y shown by a continuous black line on the attached map and described in Part 1 of the Schedule to the Order (“the Schedule”) shall be stopped up as provided below.
2. There shall be created to the reasonable satisfaction of the Council an alternative **footpath** R168y for use as a replacement for the said footpath R168y provided in Part 2 of the Schedule and shown by black dashes on the attached map
3. The stopping up of the **footpath** shall have the effect on the date on which the Council certify that the terms of Article 2 above have been complied with.

4. Where immediately before the date on which the **footpath** to be stopped up there is apparently under, in, on, over, along or across it belonging to statutory undertakers for the purpose of carrying on their undertaking, the undertakers shall continue to have the same rights in respect of the apparatus as they had
5. The following works shall be carried out in relation to the highway described in Part 2 of the Schedule

SCHEDULE

PART 1

DESCRIPTION OF SITE OF EXISING FOOTPATH

Between Points A-B

Stop up Existing footpath from point A grid reference 446290 272230 south easterly for approximately 494 metres to Point B grid reference: 446578 271830

PART 2

DESCRIPTION OF SITE OF NEW FOOTPATH

Between Points D-E-F-G-H-C on the Order Plan

From Point D grid reference 446308 272296 on Bridleway R168x east for approximately 163 metres to Point E grid reference 446466 272298 turning south for approximately 99 metres to Point F grid reference 446491 272167 curving slightly westerly for approximately 25 metres to Point G grid reference 446485 272111 curving south easterly for approximately 60 metres to Point H grid reference 446480 272062 and southerly for approximately 300 metres to Point C grid reference 446475 271820

The footpath will be 3 metres wide of natural surface

THE COMMON SEAL OF
RUGBY BOROUGH COUNCIL
was hereunto affixed
the 17 day of October 2024
in the presence of



120/24

A handwritten signature in black ink, consisting of a stylized, cursive letter 'A'.

Authorised officer on behalf of the Chief Officer for Legal and
Governance
(The Officer appointed for this purpose)

DATED 17 October 2024

TOWN AND COUNTRY PLANNING ACT 1990 SECTION 257

THE RUGBY BOROUGH COUNCIL
(FOOTPATH R168Y RUGBY)

PUBLIC PATH ORDER 2024

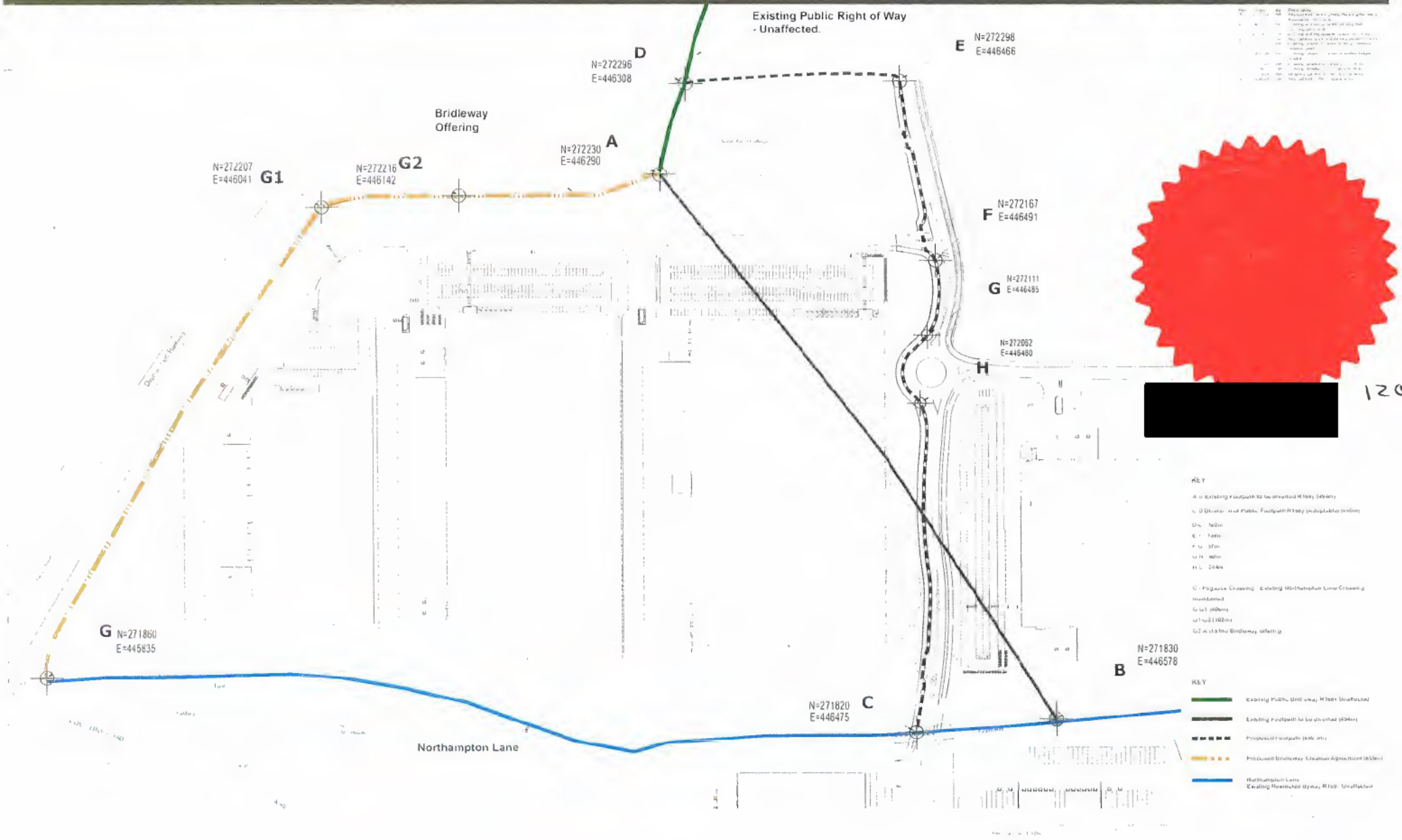

- KLY**
- A - Existing route to be diverted (494m)
 - B - Existing route to be diverted (594m)
 - C - Proposed route to be diverted (594m)
 - D - Proposed route to be diverted (594m)
 - E - Proposed route to be diverted (594m)
 - F - Proposed route to be diverted (594m)
 - G - Proposed route to be diverted (594m)
 - H - Proposed route to be diverted (594m)
- KLY**
- Existing Public Right of Way (PRoW) (Blue)
 - Existing Footpath to be diverted (Black)
 - Proposed Footpath (Black)
 - Proposed Bridleway Creation Agreement (Yellow)
 - Northampton Lane Existing (Blue)
 - Existing Northampton Lane PRoW (Blue)