

RUGBY BOROUGH COUNCIL

**TOWN AND COUNTRY PLANNING (GENERAL PERMITTED
DEVELOPMENT) ORDER 1995, AS AMENDED**

LAND AT TOP ROAD BARNACLE

TAKE NOTICE that the Rugby Borough Council have made a Direction under Article 4(1) of the Town and Country Planning (General Permitted Development) Order 1995 in respect of land at Top Road, Barnacle directing that permission by article 3 of the Order shall not apply to development on the said land as described in the Direction.

The effect of the Direction is that development of the type specified in the First Schedule must not be carried out within the area specified in the Second Schedule and shown edged red on the attached plan unless planning permission is granted by the Council on an application being made to the Council under Part III of the Town and Country Planning Act 1990.

The Direction does not take immediate effect. The Direction will only take effect if the Order is confirmed by the local authority. Any representations from persons aggrieved by the making of the Direction will be considered by the local authority before the Order is confirmed.

A copy of the Direction and a copy of the plan may be inspected at the offices of the Legal and Elections Manager of the Borough Council, Town Hall, Rugby between the hours of 9am and 5pm Monday to Friday,

Any representations should be addressed to the Legal and Elections Manager, Rugby Borough Council, Town Hall, Evreux Way, Rugby, CV21 2RR and received by 16th December 2011

Signed.......... Dated.....17th NOVEMBER 2011.....

Legal and Elections Manager

**TOWN AND COUNTRY PLANNING (GENERAL PERMITTED
DEVELOPMENT) ORDER 1995, AS AMENDED**

DIRECTION MADE UNDER ARTICLE 4(1) TO WHICH ARTICLE 5 APPLIES

LAND AT TOP ROAD BARNACLE

WHEREAS Rugby Borough Council being the appropriate local planning authority within the meaning of article 4(4) of the Town and Country Planning (General Permitted Development) Order 1995, as amended, are satisfied that it is expedient that development of the descriptions set out in the Schedule below should not be carried out on the land shown edged red on the attached plan, unless planning permission is granted on an application made under Part III of the Town and Country Planning Act 1990, as amended.

NOW THEREFORE the said Council in pursuance of the power conferred on them by article 4(1) of the Town and Country Planning (General Permitted Development) Order 1995, as amended, hereby direct that the permission granted by article 3 of the said Order shall not apply to development on the said land of the descriptions set out in the Schedule below.

FIRST SCHEDULE

Schedule 2; Part 5 of the Town and Country Planning (General Permitted Development) Order 1995, as amended

Caravan Sites

Class A

The use of the land , other than a building, as a caravan site in the circumstances referred to in Paragraph A.2

Class B

Development required by the conditions of a site licence for the time being in force under the Caravan Sites and Control of Development Act 1960.

And not being development comprised within any other class.

SECOND SCHEDULE

Description of Land

Land at Top Road Barnacle and shown edged red on the attached plan.

- 1) Made under the Common Seal of Rugby Borough Council
this 16th day of November 2011.

The Common Seal of the Council was affixed to this Direction

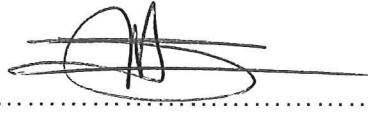

In the presence of

Mark Neale

Legal and Elections Manager

99/11

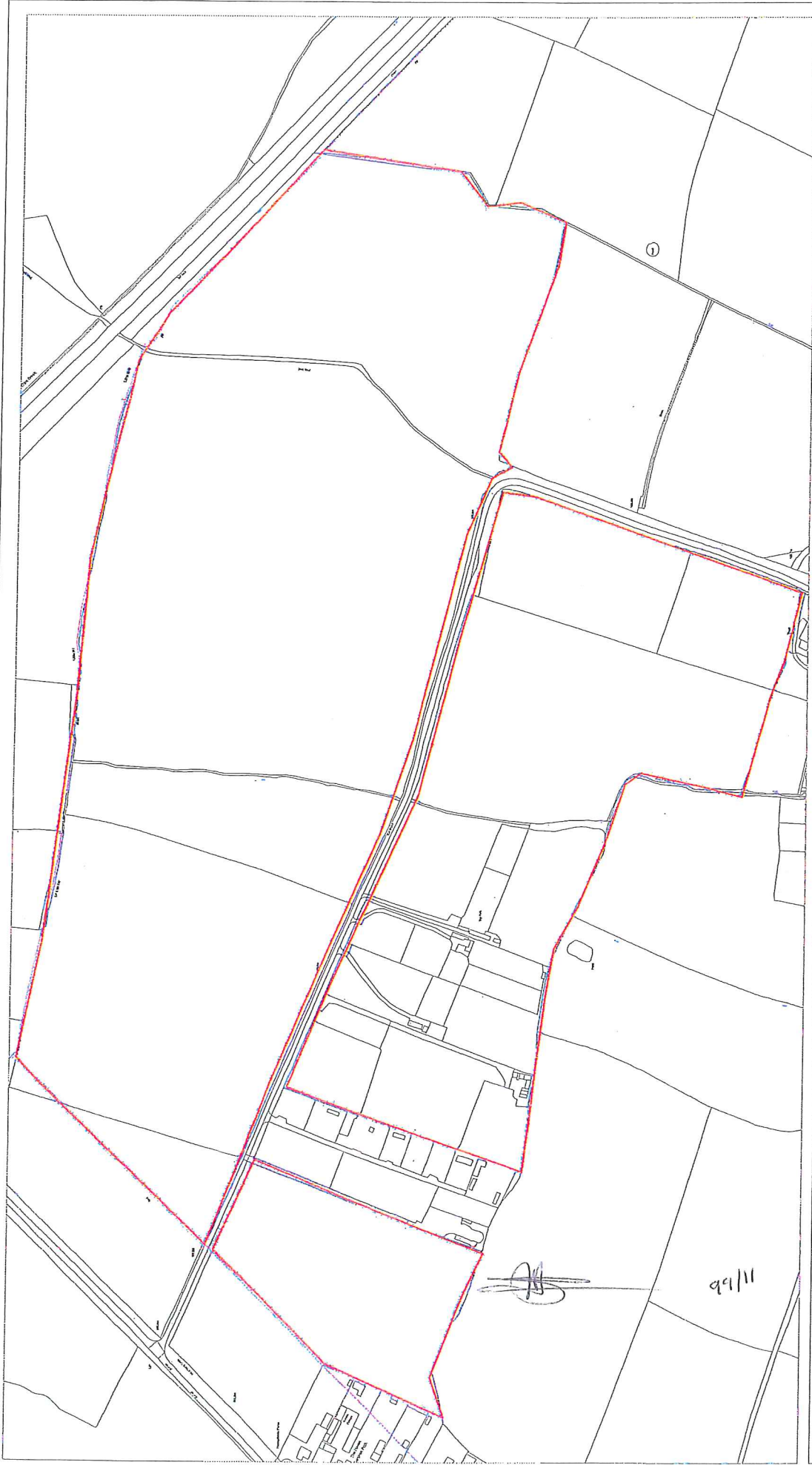

**FOR REFERENCE PURPOSES ONLY
NO FURTHER COPIES MAY BE MADE**

PLANNING AND CULTURE SERVICES

Town Hall, Rugby, CV21 2RR.
Tel. No. (01788) 535533 Fax. No. (01788) 533778

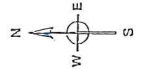

**Land at Top Road
Barnacle**

Grid Ref.	Date	Scale
438546 285452	19/1/2011	1:5000

This map is based upon Ordnance Survey material with the permission of Ordnance Survey on behalf of the Controller of Her Majesty's Stationery Office. (c) Crown copyright. Unauthorised reproduction infringes Crown copyright and may lead to prosecution or civil proceedings. Rugby Borough Council. 100019417.

